



The
ALEXANDER HOTEL
Collection

Meetings

Events

AH
ALEXANDER HOTELS
COLLECTION
Distinctive luxury hotels in Surrey, Sussex

Creative Spaces

at

The ALEXANDER HOTEL Collection

From the historic Tithe Barn at Great Fosters, to the sleek Pavilion of Rowhill Grange, our collection of historic country house hotels feature all manner of creative, inspiring and luxurious spaces.



Established for over twenty years, we are proud to have created a legacy of superb events delivered by our team of exceptional event professionals.

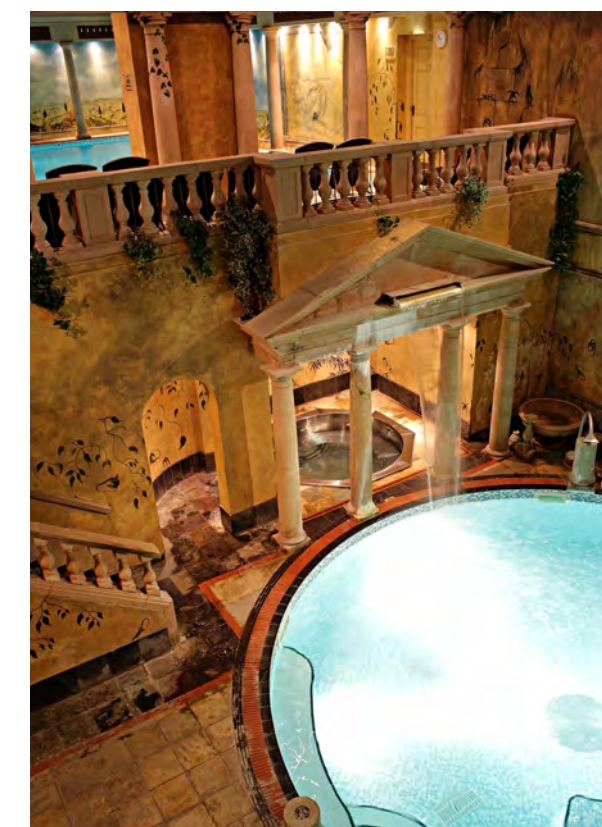
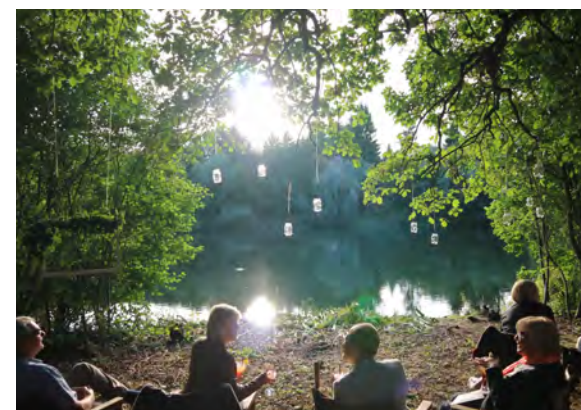

Alexander House

TURNER'S HILL, EAST GRINSTEAD, RH10 4QD | WWW.ALEXANDERHOUSE.CO.UK

A transformed Jacobean mansion, Alexander House was once the residence of Percy & Mary Shelley. Today, our five-red star property is comprised of 58 rooms & suites, 7 private hire spaces, a champagne bar, several terraces and courtyards and a Utopia spa. Our largest suite, named after the Shelleys, holds 90 guests and can be combined with the Wakehurst for larger events of up to 130. More intimate occasions can enjoy such beautiful drawing rooms as the Asquith & Churchill.

Set in 120 acres of gardens, Alexander House is just 20 minutes from Gatwick Airport and 30 minutes from London Victoria.

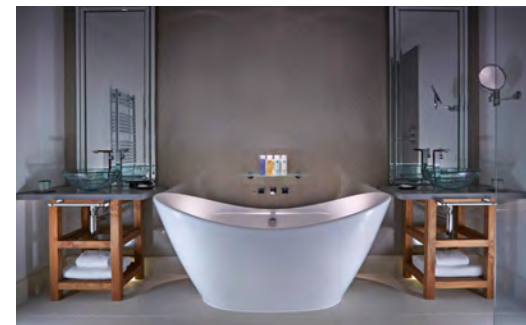

	Shelley	Wakehurst	Asquith	Churchill	Chalfont	The Boardroom	AG's
Boardroom	40	26	8	14	10	10	30
Private Dining	90	40	10	16	14	10	40
Cabaret	56	24	~	~	~	~	16
U-Shape	40	24	~	12	~	~	16
Theatre	90	40	~	16	~	~	40



CLOCKWISE FROM LEFT: *The Asquith Suite, a Garden Suite bedroom, the original manor and gardens, spa garden at Utopia Spa, Champagne Bar, Shelley Suite*



ASQUITH SUITE

Perfectly formed traditional suite with views of the south gardens.



ASQUITH SUITE
20.1ft x 13.5ft
6.1m x 4.1m

BOARDROOM
up to 8 delegates

PRIVATE DINING
up to 10 guests

THE BOARDROOM

Fully air-conditioned modern boardroom offering a comfortable environment for high power executive meetings.



THE BOARDROOM
22.7ft x 16.1ft
6.9m x 4.9m

BOARDROOM
up to 10 delegates

CHALFONT SUITE

Intimate suite that retains elegant 17th Century oak panelling.

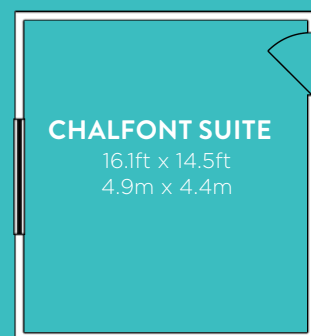

CHALFONT SUITE
16.1ft x 14.5ft
4.9m x 4.4m

BOARDROOM
up to 10 delegates

PRIVATE DINING
up to 12 guests

CHURCHILL SUITE

Luxuriously appointed south facing room that lends itself to the modern business meeting but also suits a special occasion or business supper.



CHURCHILL SUITE
18.11ft x 16.6ft
5.8m x 5.0m

BOARDROOM
up to 14 delegates

U-SHAPE
up to 12 delegates

THEATRE STYLE
up to 20 delegates

PRIVATE DINING
up to 16 guests

SHELLEY SUITE

Purpose built suite equipped with modern technology, stage setting or dance floor, air-conditioning and direct access to a private garden.

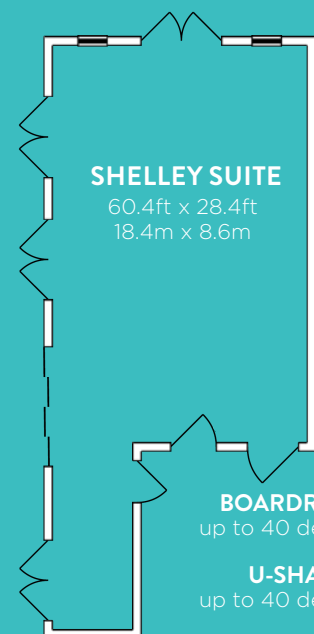

SHELLEY SUITE
60.4ft x 28.4ft
18.4m x 8.6m

BOARDROOM
up to 40 delegates

U-SHAPE
up to 40 delegates

CABARET
up to 56 delegates

THEATRE STYLE
up to 90 delegates

PRIVATE DINING
up to 90 guests

WAKEHURST SUITE

Syndicate area or private meeting room with direct access to a discreet terrace.

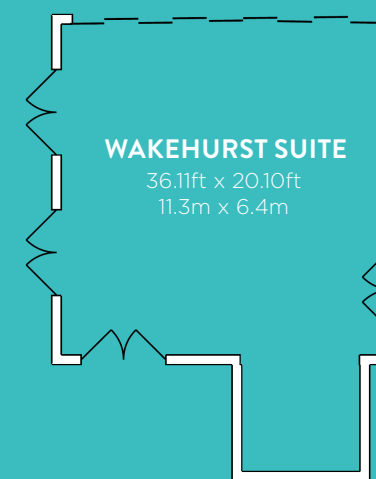

WAKEHURST SUITE
36.11ft x 20.10ft
11.3m x 6.4m

BOARDROOM
up to 26 delegates

U-SHAPE
up to 24 delegates

CABARET
up to 24 delegates

THEATRE STYLE
up to 40 delegates

PRIVATE DINING
up to 40 guests

AG's

Elegant decor and tastefully appointed furnishings suited to a variety of room layouts.

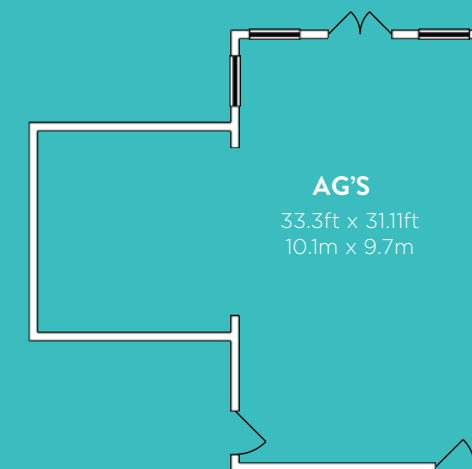

AG'S
33.3ft x 31.1ft
10.1m x 9.7m

BOARDROOM
up to 20 delegates

U-SHAPE
up to 14 delegates

CABARET
up to 15 delegates

THEATRE STYLE
up to 30 delegates

PRIVATE DINING
up to 40 guests



Great Fosters

STROUDE ROAD, EGHAM, NEAR WINDSOR TW20 9UR | WWW.GREATFOSTERS.CO.UK

One of the most important historic buildings in the UK, Great Fosters is steeped in Tudor history. This magnificent boutique hotel has acres of glorious gardens (ideal for team building), 56 rooms & suites, 7 private hire spaces, a Cocktail Bar, Painted Hall Bar, several terraces with a wood fired pizza oven and much more - including a Saxon moat and grassed amphitheatre! Great Fosters is mere moments from London Heathrow and 40 minutes from London Waterloo and accommodates up to 120 guests theatre style in the ancient Tithe Barn. Smaller meetings are perfectly suited to the self contained Coach House which includes three ground floor meeting spaces, spacious lounge and walled garden.



	Tithe Barn	Orangery	Mowbray	Mandeville	Clarence	Victoria	Concord
Boardroom	40	40	20	8	22	16	10
Private Dining	180	80	24	8	~	~	~
Cabaret	42	48	15	~	~	~	~
U-Shape	40	40	20	~	22	16	10
Theatre	120	120	30	~	30	~	~



CLOCKWISE FROM TOP LEFT: *The Tithe Barn, the Clarence, Great Fosters across the parterres, the Mowbray, the view from the tower, the Orangery*

THE COACH HOUSE

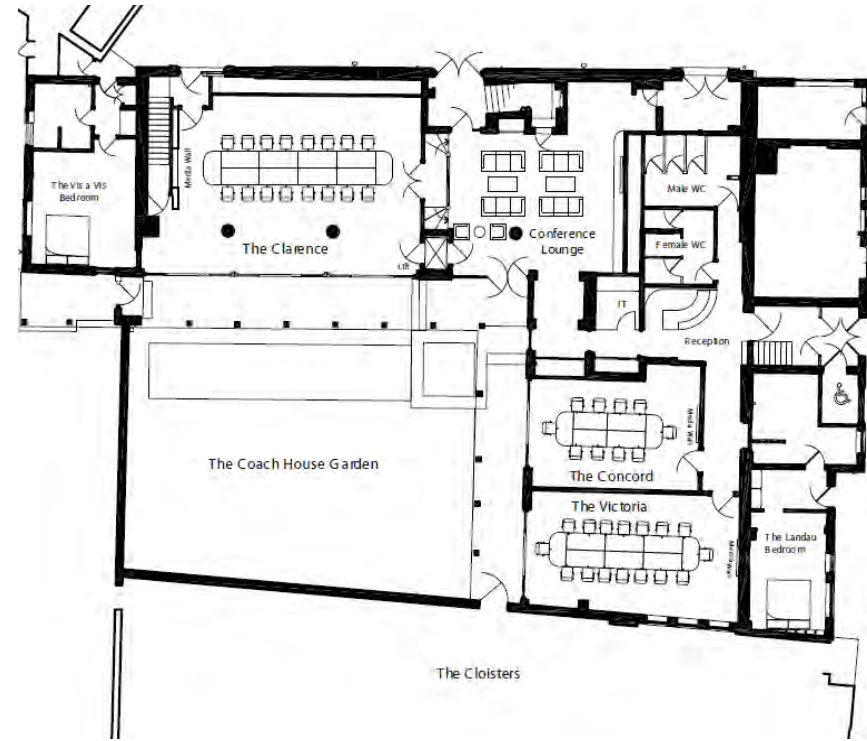

TITHE BARN EVENT SPACE

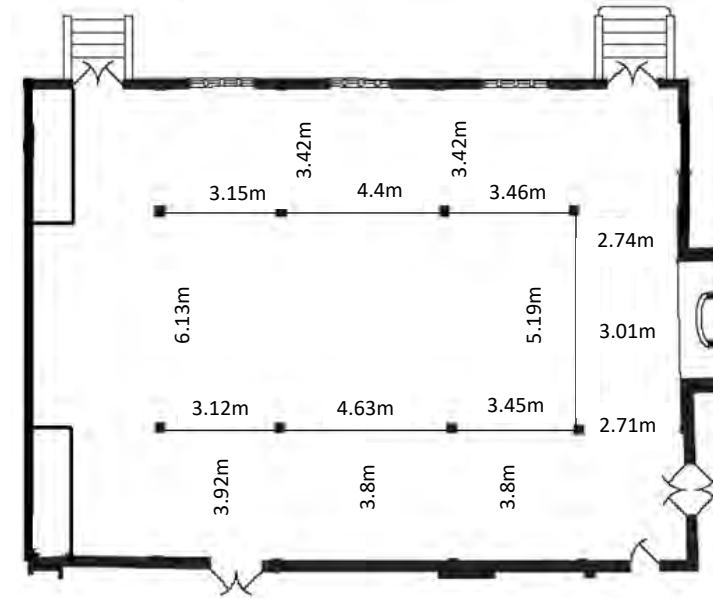

THE MOWBRAY & MANDEVILLE

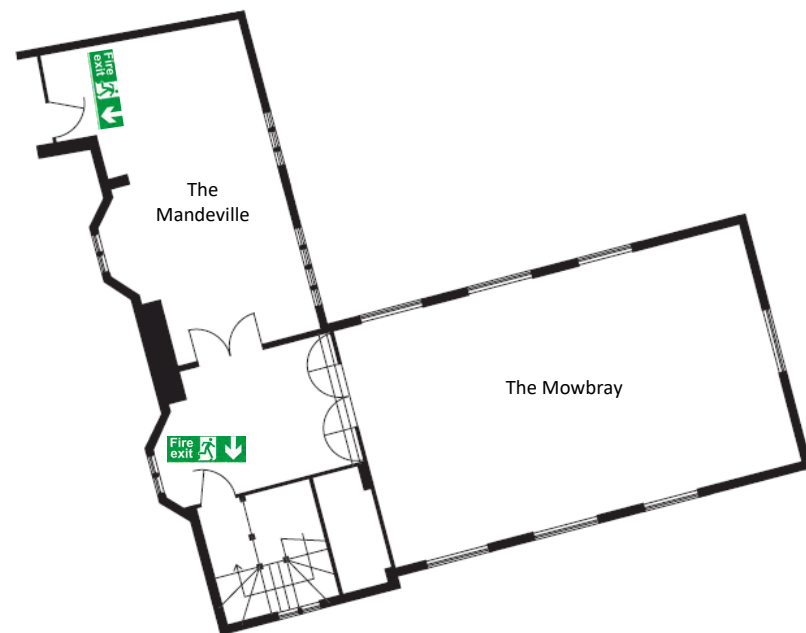

THE ORANGERY

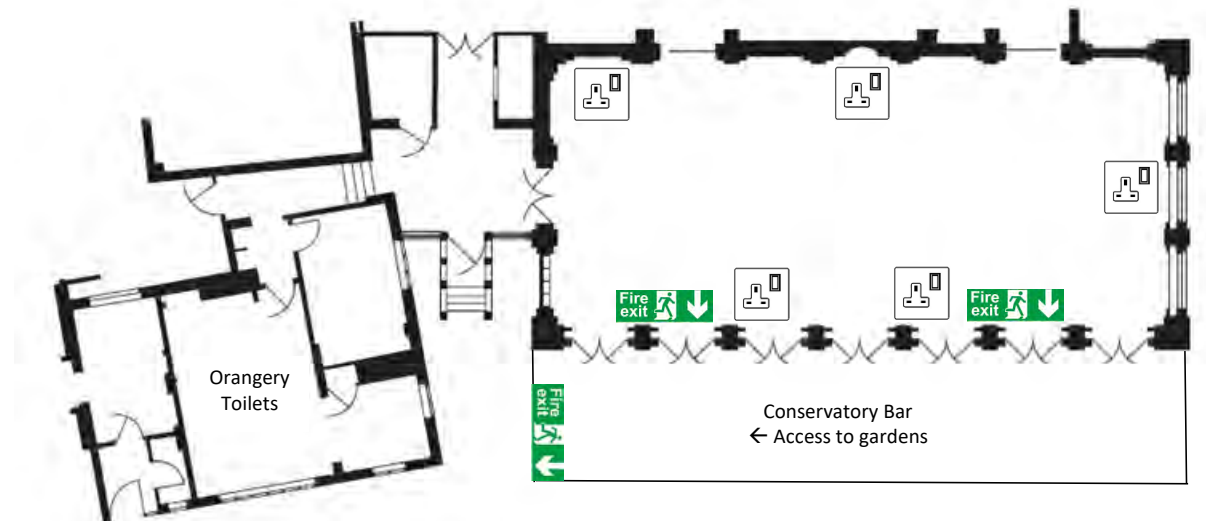

Rowhill Grange

TOP DARTFORD ROAD, DARTFORD, KENT DA2 7QH | WWW.ROWHILLGRANGE.CO.UK

Rowhill Grange is undeniably beautiful - originally built as a holiday home for Alice Alexander over 150 years ago, it still bears a New England charm and certainly evokes the sense of escape. With 38 rooms & suites, 6 meeting rooms and 15 acres of gardens it perfectly caters for smaller and larger groups alike. The Pavilion and The Clockhouse are both separate to the Main House and offer exclusive use options. Additionally, Rowhill Grange has several terraces overlooking the gardens, Elements Bar & Lounge and the rosetted restaurant, RGs. Rowhill Grange is just 12 miles from London City Airport, and 30 minutes from London Victoria to Swanley Station, 2 miles from the hotel.



	Pavilion	Hub	Wicket	Drawing Room	Clockhouse Suite	Cottage Suite
Boardroom	24	8	18	14	34	26
Private Dining	~	~	~	16	130	32
Cabaret	30	~	~	~	40	15
U-Shape	22	10	12	15	30	26
Theatre	60	~	20	20	160	64

CLOCKWISE FROM TOP LEFT: A Master Suite, RG's Restaurant, the Gardens, The Pavilion meeting room, private dinner in The Drawing Room and the indoor pool at Utopia Spa.



THE PAVILION

CONFERENCE CENTRE
Stylishly designed intelligent 'think space' environment with modern technology, mood lighting, reception area and private terrace.

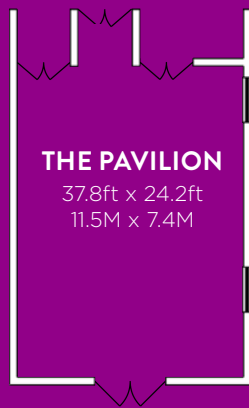

THE PAVILION
37.8ft x 24.2ft
11.5M x 7.4M

BOARDROOM
up to 24 delegates

U-SHAPE WITH TABLES
up to 22 delegates

U-SHAPE WITHOUT TABLES
up to 26 delegates

CABARET
up to 30 delegates

THEATRE STYLE
up to 60 delegates

THE HUB

Located on the upper floor of The Pavilion, The Hub is an elegant meeting space appropriate for cosy gatherings.

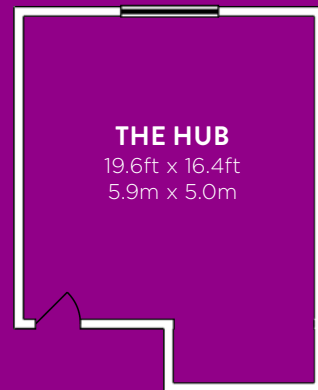

THE HUB
19.6ft x 16.4ft
5.9m x 5.0m

BOARDROOM
up to 8 delegates

U-SHAPE WITH TABLES
up to 10 delegates

U-SHAPE WITHOUT TABLES
up to 12 delegates

THE WICKET

Adjacent to The Hub offering an intimate atmosphere and sophisticated setting.



THE WICKET
34.1ft x 16.4ft
10.4m x 5.0m

BOARDROOM
up to 18 delegates

U-SHAPE WITH TABLES
up to 12 delegates

U-SHAPE WITHOUT TABLES
up to 14 delegates

THEATRE STYLE
up to 20 delegates

THE DRAWING ROOM

Oak-panelled boardroom that artfully blends 18th century charm with modern amenities and garden views.

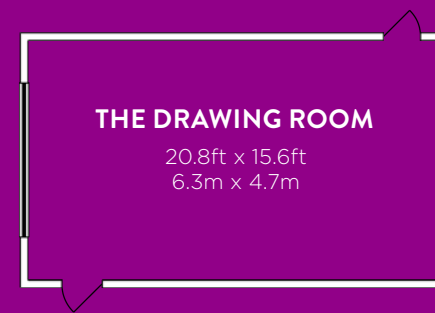

THE DRAWING ROOM
20.8ft x 15.6ft
6.3m x 4.7m

BOARDROOM
up to 14 delegates

U-SHAPE WITH TABLES
up to 15 delegates

U-SHAPE WITHOUT TABLES
up to 20 delegates

THEATRE STYLE
up to 20 delegates

CLOCKHOUSE SUITE

A gracious setting with plenty of natural character. Equipped with modern technology, stage setting or dance floor, air conditioning, private bar and courtyard.

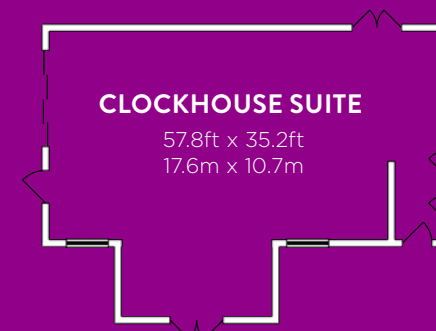

CLOCKHOUSE SUITE
57.8ft x 35.2ft
17.6m x 10.7m

BOARDROOM
up to 34 delegates

U-SHAPE WITH TABLES
up to 30 delegates

U-SHAPE WITHOUT TABLES
up to 36 delegates

CABARET
up to 40 delegates

THEATRE STYLE
up to 160 delegates

PRIVATE DINING
up to 150 guests

COTTAGE SUITE

Named accordingly because of its cosy fireplace and warm atmosphere.

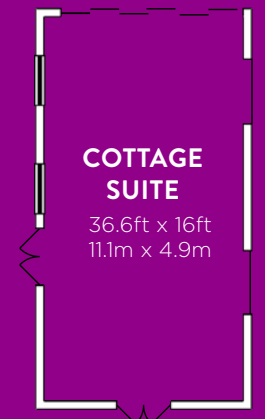

COTTAGE SUITE
36.6ft x 16ft
11.1m x 4.9m

BOARDROOM
up to 26 delegates

U-SHAPE WITH TABLES
up to 23 delegates

U-SHAPE WITHOUT TABLES
up to 26 delegates

CABARET
up to 15 delegates

THEATRE STYLE
up to 64 delegates

Barnett Hill

BLACKHEATH LANE, NEAR GUILDFORD, GU5 0RF | WWW.BARNETHILLHOTEL.CO.UK

Barnett Hill is truly a treasure of a property tucked away behind a sweeping driveway high in the Surrey Hills. Its rich history began as a private residence for the Thomas Cook family, before going on to become a Red Cross Hospital during WW2. Barnett Hill today is a beautiful design hotel with 56 rooms & suites, 9 private hire spaces, a series of terraces which look over 26 acres of grounds and a beautiful rosetted restaurant, The Oak Room and the 1905 cocktail bar. Barnett Hill can accommodate up to 100 guests and makes a perfect option for exclusive hire. Located 26 miles from Heathrow and 37 from Gatwick, Barnett Hill is easily reachable with connections via Guildford.

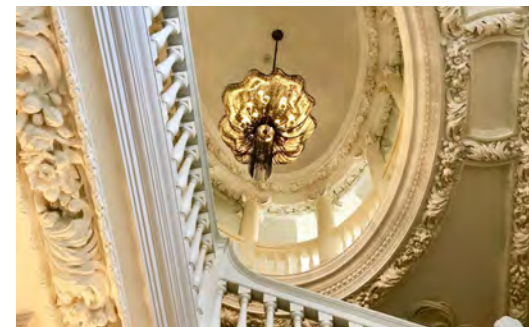

	Garden Suite	Chestnut	Acer	Drawing Room	Wine Room	Feathers	Ewhurst	Dunsfold	Chilworth	Bramley	Albury
Boardroom	32	18	10	24	~	~	14	10	12	14	16
Private Dining	80	25	12	40	8	12	~	~	~	~	~
Cabaret	45	16	8	30	~	~	~	~	~	~	~
U-Shape	30	18	12	26	~	~	12	12	12	10	16
Theatre	100	30	15	70	~	~	~	~	~	8	~

CLOCKWISE FROM TOP LEFT: *The Drawing Room, central staircase, Barnett Hill across the lawn, the Chestnut, main hallway, Beatrice Cook Master Suite*



BARNETT HILL

Country House Hotel

★ ★ ★ ★



GARDEN SUITE

CHESTNUT

ACER

DRAWING ROOM

EWHURST

DUNSFOLD

CHILWORTH

BRAMLEY

ALBURY

The largest meeting room with views onto the gardens to the side of the house. The Garden is air-conditioned, has natural daylight and is a great setting for larger conferences.

Located on the first floor, this meeting room is south facing, benefiting from natural daylight.

A first floor meeting room with views over the grounds. Can interconnect with the Chestnut Suite.

An attractive walnut-panelled room with beautiful period features. It is a particularly special setting for senior-level strategy meetings, exclusive corporate entertaining and AGMs.

Tucked away in the peaceful eaves at the top of the house on the second floor.

Located on the second floor with panoramic views of the surrounding countryside.

A small meeting room located on the second floor with panoramic views of the countryside.

A small meeting room located on the second floor with panoramic views of the countryside. Can interconnect with Albury.

A small meeting room located on the second floor with panoramic views of the countryside. Can interconnect with Bramley.

GARDEN SUITE

35ft x 23ft
10.7m x 7m

CABARET

up to 45 delegates

HOLLOW SQUARE
up to 32 delegates

BOARDROOM
up to 32 delegates

CLASSROOM
up to 40 delegates

THEATRE
up to 100 delegates

U-TABLES
up to 30 delegates

U-CHAIRS
up to 30 delegates

DINNER
up to 80 guests

CHESTNUT

24ft x 14.4ft
7.1m x 4.4m

CABARET

up to 16 delegates

HOLLOW SQUARE
up to 18 delegates

BOARDROOM
up to 18 delegates

CLASSROOM
up to 24 delegates

THEATRE
up to 30 delegates

U-TABLES
up to 16 delegates

U-CHAIRS
up to 18 delegates

DINNER
up to 25 delegates

ACER

15.5ft x 11ft
4.75m x 4.6m

CABARET

up to 8 delegates

HOLLOW SQUARE
up to 10 delegates

BOARDROOM
up to 10 delegates

CLASSROOM
up to 4 delegates

THEATRE
up to 15 delegates

U-TABLES
up to 8 delegates

U-CHAIRS
up to 12 delegates

DINNER
up to 12 delegates

DRAWING ROOM

29ft x 17ft
8.8m x 5.25m

CABARET

up to 30 delegates

HOLLOW SQUARE
up to 24 delegates

BOARDROOM
up to 24 delegates

CLASSROOM
up to 30 delegates

THEATRE
up to 70 delegates

U-TABLES
up to 16 delegates

U-CHAIRS
up to 26 delegates

DINNER
up to 40 guests

EWHURST

15ft x 12ft
4.6m x 3.7m

BOARDROOM
up to 14 delegates

U-CHAIRS
up to 12 delegates

DUNSFOLD

15ft x 12.4ft
4.6m x 3.8m

BOARDROOM
up to 10 delegates

U-CHAIRS
up to 12 delegates

CHILWORTH

18ft x 11.8ft
5.5m x 3.6m

BOARDROOM
up to 12 delegates

U-TABLES
up to 10 delegates

U-CHAIRS
up to 12 delegates

BRAMLEY

15.7ft x 12.5ft
4.8m x 3.8m

BOARDROOM
up to 14 delegates

THEATRE
up to 8 delegates

U-CHAIRS
up to 10 delegates

ALBURY

27ft x 12ft
8.2m x 3.6m

BOARDROOM
up to 16 delegates

U-CHAIRS
up to 16 delegates

Langshott Manor

LADBROKE ROAD, HORLEY, SURREY RH6 8PB | WWW.LANGSHOTTMANOR.CO.UK

Langshott Manor dates back to 1580 making it our second Tudor-era property. Very much in the Elizabethan style, Langshott Manor is charming and characterful with warm, exposed original brickwork, wooden beams and roaring fireplaces. Now the hotel is home to 22 rooms and suites, 4 private hire spaces, our beautiful three-rosette restaurant The Mulberry as well as terraces overlooking the beautiful garden and original moat. More a house than hotel, Langshott Manor is perfect for exclusive use and you can expect an especially warm welcome and to feel right at home. The hotel is just five minutes from Gatwick and under an hour to London Victoria from the Horley connection.



	Gallery	Boardroom	Mulberry
Boardroom	12	20	30
Private Dining	14	22	60
Informal	~	~	~
U-Shape	12	14	24
Theatre	10	25	60

CLOCKWISE FROM LEFT: *The Boardroom, the Morning Room, Langshott Manor, the lounge, a splendid suite, rosetted cuisine in The Mulberry*



THE GALLERY



THE BOARDROOM



ST PETER'S



MULBERRY

Perfectly formed traditional suite with views of the south gardens

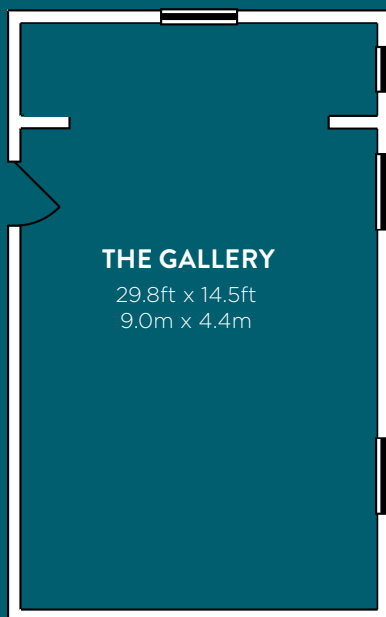

THE GALLERY
29.8ft x 14.5ft
9.0m x 4.4m

- BOARDROOM**
up to 12 delegates
- CLASSROOM**
up to 12 delegates
- U-SHAPE**
up to 12 delegates
- THEATRE**
up to 10 delegates
- RECEPTION**
up to 30 delegates
- PRIVATE DINING**
up to 14 guests

Well-appointed with oak wall coverings and comfortable seating. The room overlooks the hotel's medieval moat and offers access to a private deck with outdoor seating.



THE BOARDROOM
24.3ft x 16ft
7.4m x 4.9m

- BOARDROOM**
up to 20 delegates
- CLASSROOM**
up to 16 delegates
- U-SHAPE**
up to 14 delegates
- THEATRE**
up to 25 delegates
- RECEPTION**
up to 25 delegates
- PRIVATE DINING**
up to 22 guests

Situated in the oldest part of the 16th century house, featuring an open log fireplace, oak beams, views of the manicured grounds and an original door leading onto the terrace.

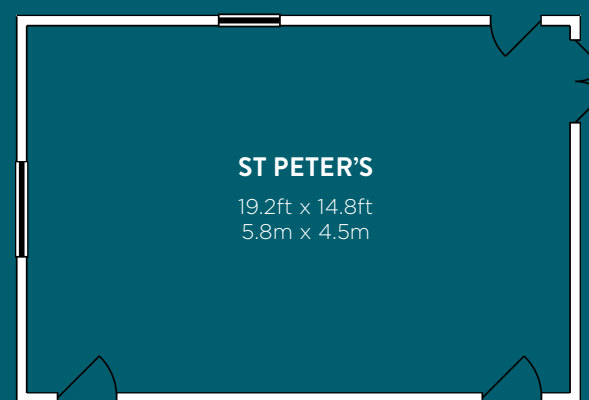

ST PETER'S
19.2ft x 14.8ft
5.8m x 4.5m

INFORMAL SEATING ONLY
up to 16 delegates

An inspirational setting with windows denoting an entire side of the room for maximum sunlight.

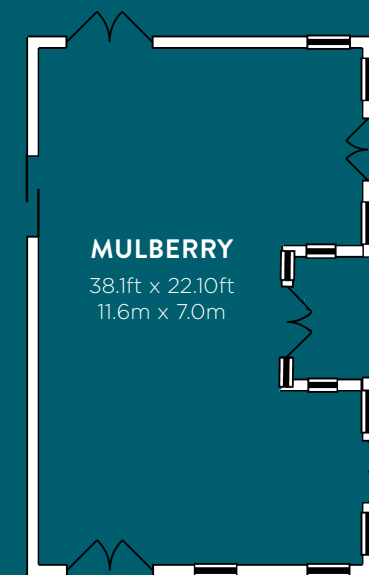

MULBERRY
38.1ft x 22.10ft
11.6m x 7.0m

- BOARDROOM**
up to 30 delegates
- CLASSROOM**
up to 20 delegates
- U-SHAPE**
up to 24 delegates
- THEATRE**
up to 60 delegates
- PRIVATE DINING**
up to 60 guests

Team Building at The AH

All our hotels boast extraordinary gardens and grounds, and with our little black book of suppliers, we have plenty of great team building solutions. From ice breakers to creative exercises, learning new skills as well as more traditional team building activities, there's something for every team to enjoy. Here are a few of our favourites...



You'd be quackers not to give duck herding in the grounds a go... great at all our hotels



An afternoon of croquet on the lawn perhaps? Why not accompany it with cream tea & Pimms... a lovely treat. There are plenty of other lawn games too... Available at all our hotels.



A morning of clay shooting blows away the cobwebs, with flasks of coffee & treats - ideal at Alexander House, Barnett Hill and Great Fosters



An It's a Knockout Competition is sure to get the whole team bonding & laughing - we can organise this afternoon of fun at Alexander House, Barnett Hill, Great Fosters or Rowhill Grange.



The primordial power of gathering around fire - with a tot of something or two! A possibility at all our hotels.



Need we say more? We love this snap of a team enjoying a wine tasting, which you can take as seriously (or not) as you please. We've plenty of grapes to try and our sommeliers know their stuff but can make a tasting great fun too. Or we can invite a local distillery or vineyard to come and play...

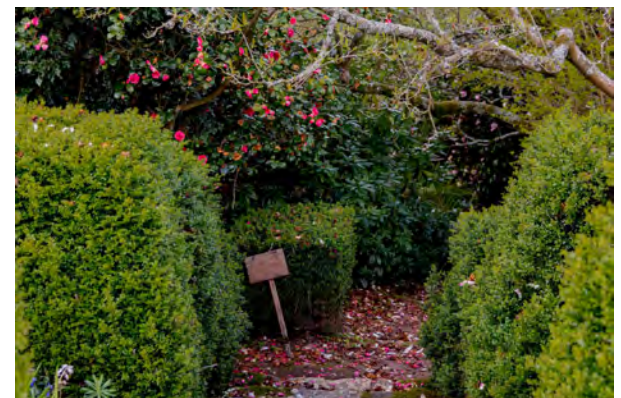

A guided wellness walk through our woodland at Alexander House or Barnett Hill or a stroll round the lake at Great Fosters can be great to help bring stretched teams together. Take a deep breath and recalibrate.

We've plenty more ideas too, from treasure hunts to bike rides, knock out tennis championships to wine or spirit tastings. For any of these, or perhaps something else you have in mind, just contact our events teams.

For more information please contact the properties below

Sophie Trendell-Allen

ALEXANDER HOUSE - ahsales@alexanderhotels.com

Carla Bowles

GREAT FOSTERS - gfsales@alexanderhotels.com

Besky Bell

ROWHILL GRANGE - rgsales@alexanderhotels.com

Gemma Poole

BARNETT HILL - bhsales@alexanderhotels.com

Sophie Trendell-Allen

LANGSHOTT MANOR - lmsales@alexanderhotels.com

www.alexanderhotels.co.uk

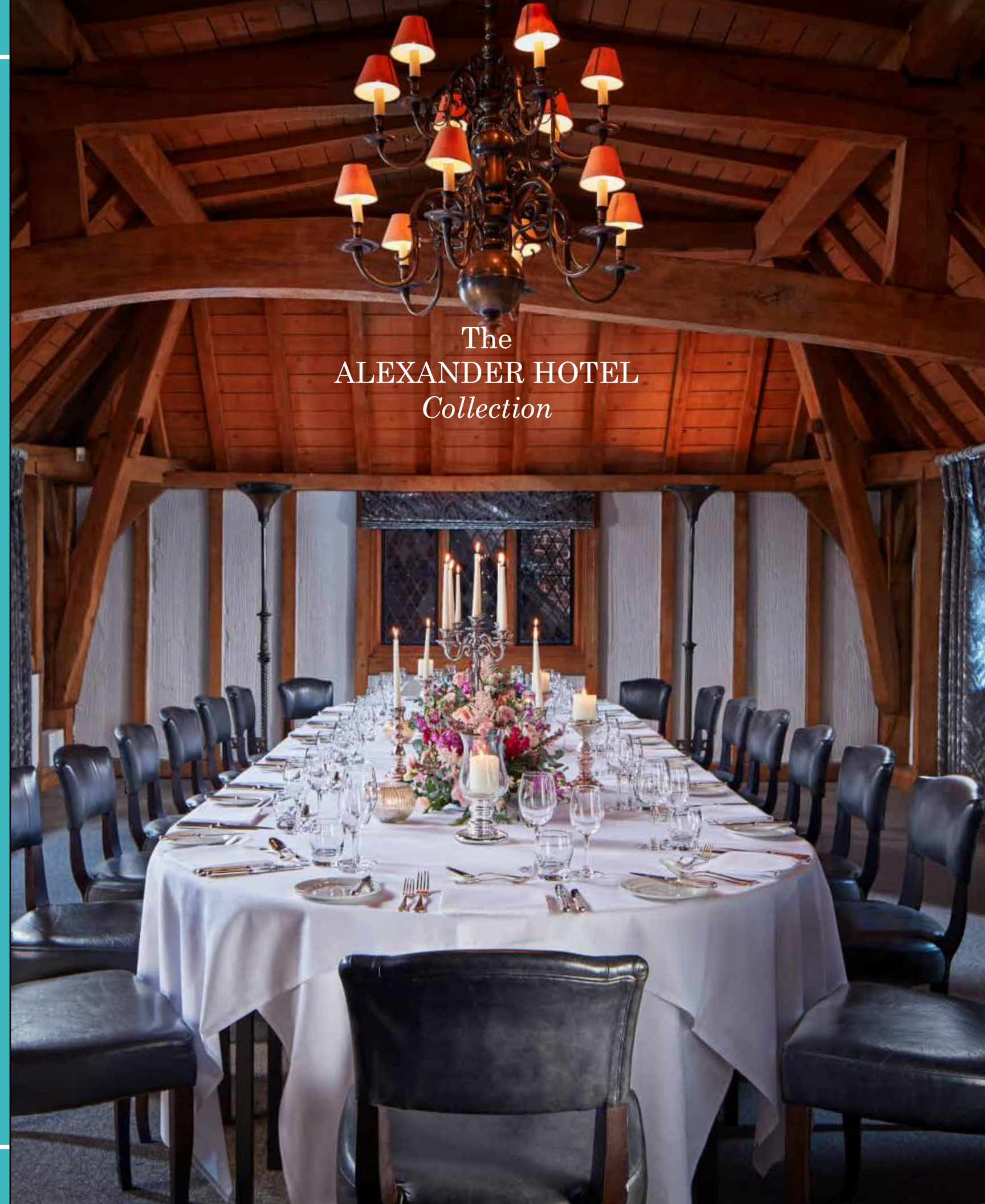

The
ALEXANDER HOTEL
Collection